

1. Names and Parts

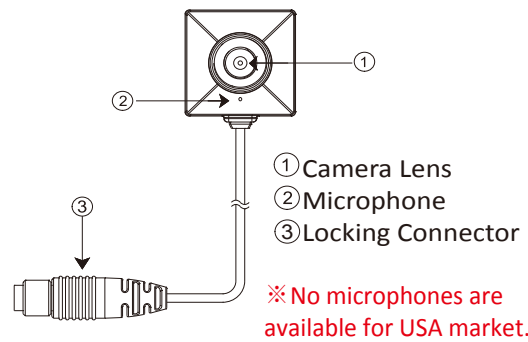

2. Package Content

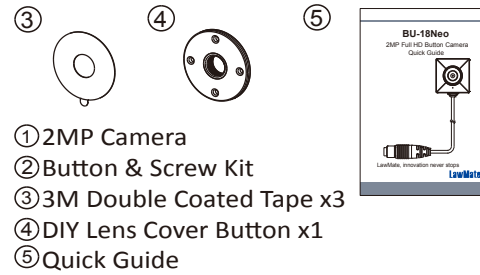
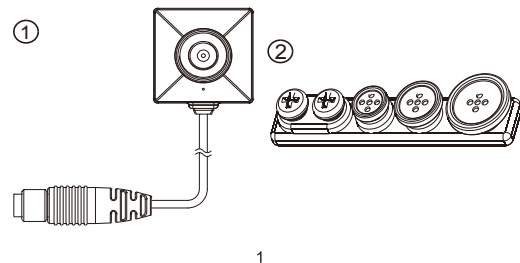

※ Do not remove serial number sticker!
Warranty is invalid if the sticker is tampered.

3. Camera Setup Illustration

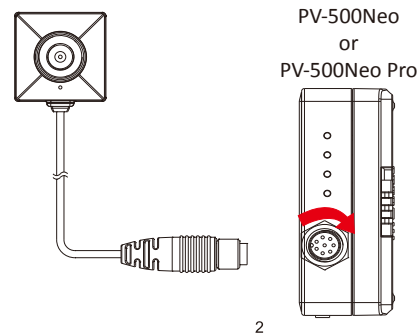

To connect the camera to the DVR, fully plug the camera's connector end into the **Camera In** port on the DVR, then lock the connector firmly by rotating it to the direction of the red arrow.

※ Only connect the camera to DVR when the DVR is powered off.

※ Before turning on the DVR, make sure the camera is already connected and memory card is inserted.

※ BU-18Neo is only compatible with PV-500Neo & PV-500Neo Pro.

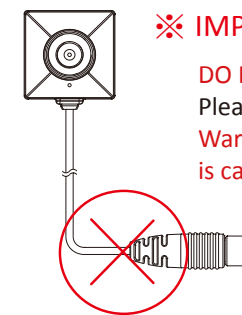

※ **IMPORTANT**

DO NOT pull on cable.
Please disconnect at base.
Warranty is invalid if damage is caused by misuse.

4. Put on Lens Covert Cap (Button and Screw)

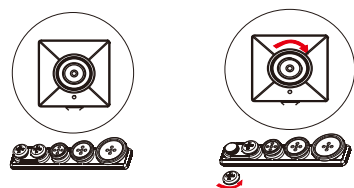

1. Unscrew the preferred lens covert cap at counterclockwise direction to remove it from the set.
2. Place the removed lens covert cap onto camera lens.
3. Screw at clockwise direction to attach the cap to the camera.

5. Put on DIY Lens Cover Button

Stick the tape on the button and screw it on the camera.

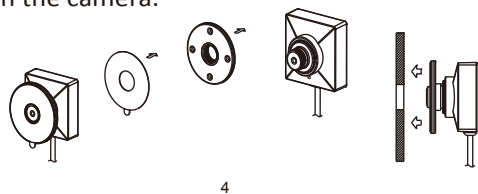

6. Specification

Resolution	
Video Resolution	1080P
Pixel Size	2.8um(H) * 2.8um(V)
Digital Picture Resolution	(H)1920 x (V)1080
CMOS Camera Module	
Built-in Image Sensor	Progressive 1/2.9 inch SONY CMOS
Illumination Sensitivity	0.1 Lux @ F2.0 50IRE
Lens F/No	F2.0
Lens Diameter	4.3 mm
Angle of View	78.2°
Depth of Field	50 cm ~ ∞
Electronic Shutter	1/8 ~ 1/30,000
Video Output	
Video Output	I2C Data
Power	
Power Supply Voltage	DC 3.3 V ± 5%
Power Supply Current	220 mA
Physical	
Operating Temperature	-10°C ~ 60°C
Operating Humidity	20 ~ 90%
Storage Temperature	-30°C ~ 80°C
Dimension	25 x 25 x 17 mm
Weight	18 g

※ This product is for Law Enforcement and Home Security Use Only!

BU-18Neo 2MP Full HD Button Camera Quick Guide

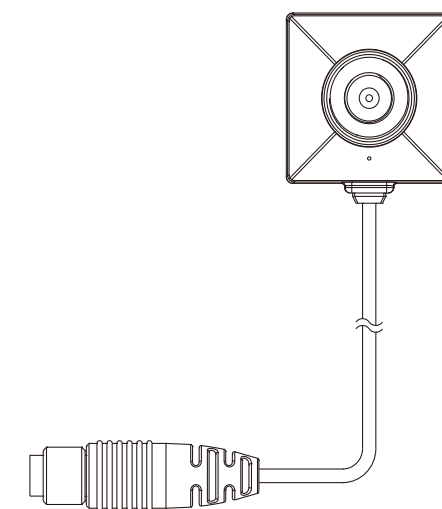

LawMate, innovation never stops

LawMate