

### 1. Name and Parts

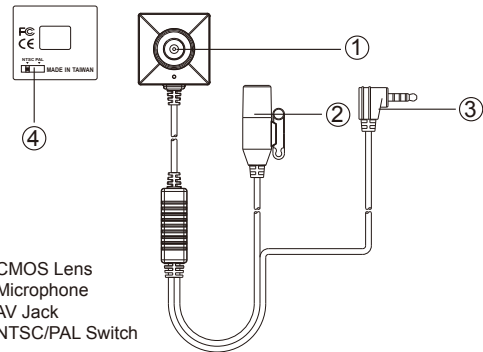

- 1. CMOS Lens
- 2. Microphone
- 3. AV Jack
- 4. NTSC/PAL Switch

### 2. Package Content

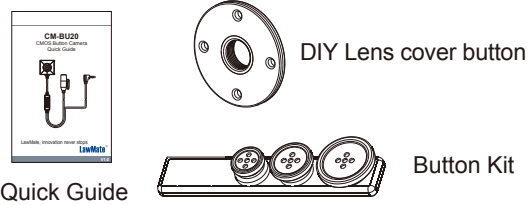

Quick Guide

DIY Lens cover button

Button Kit

1

### 3. Select Video Signal System

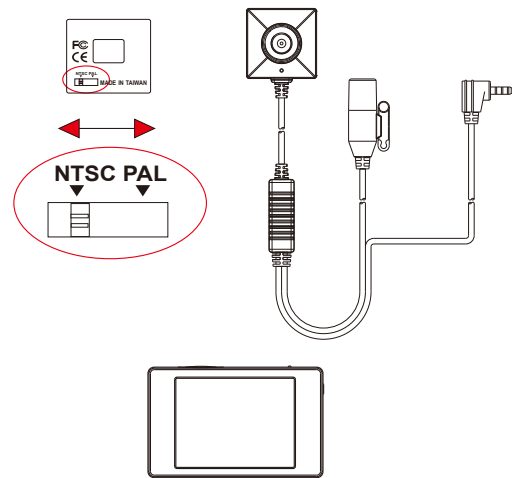

- 1. NTSC / PAL switch is on the back of the camera.
- 2. Make sure the video system is selected before turning on the DVR.

※ Do not remove serial number sticker!  
Warranty is invalid if the sticker is tampered.

2

### 4. Camera Setup Illustration

Connection with a portable DVR:

- 1. Select NTSC or PAL on the camera.
- 2. Plug in the camera into CAM IN socket on the DVR.
- 3. Power on DVR and press REC button to start recording.

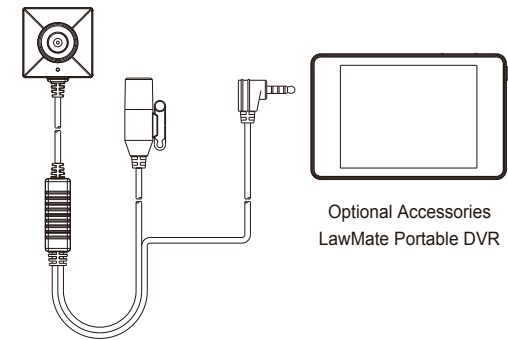

Optional Accessories  
LawMate Portable DVR

3

### 5. Specification

Model Number	CM-BU20
Image Pick-up Device	1/4-Inch CMOS ( 4 : 3 )
Effective Picture Elements	NTSC: 720H x 480V , PAL:720H x 576V (H*V)
Frequency	NTSC: 15.734KHz(H), 59.94Hz(V); PAL: 15.625KHz(H), 50Hz(V)
Horizontal Resolution	520 TV lines
Minimum Illumination	0.015Lux @ F1.2
Angle of View	66°
S/N Ratio	More than 45dB
Auto Electronic Shutter	NTSC:1/60s~1/100,000s, PAL:1/50s~1/110,000s
Gamma Characteristic	0.45γ
Gain Control	Automatically
White Balance	Automatically (2300°K~8600°K)
Synchronous System	Negative sync. Internal
Video Output	1 Vp-p Composite Video / 75 Ohms.
Power Supply	DC 5V / 150 mA
Operating Temp.	-10℃ to 50℃ (14°F to 122°F)
Dimensions	24.8mm(L) * 24.8 mm (W) * 17 mm(H)

※ This product is for Law Enforcement and Home Security Use Only!

4

## CM-BU20 CMOS Button Camera Quick Guide

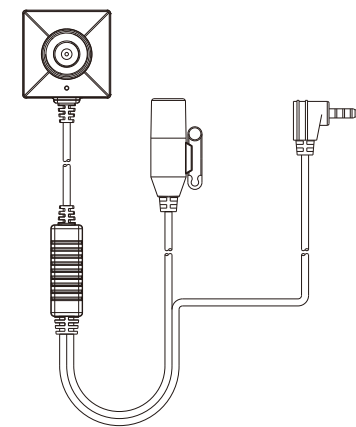

LawMate, innovation never stops

**LawMate**<sup>®</sup>

V1.1